

iHFG Standard Components

Room Layout Sheet

Room Name | Office - 3 Person Shared

RLS Room Code OFF-3P-I

RDS Room Code OFF-3P-I

Abbreviations

CHEO	CHAIR ERGONOMIC - OFFICE
CMP	COMPUTER: VIDUAL DISPLAY UNIT AND KEYBOARD
COH	COAT HOOK
COM/1	COMMUNICATION OUTLET - SINGLE
COM/2	COMMUNICATION OUTLET - DOUBLE
DKW	DESK: WORKSTATION
FCB/4D	FILING CABINET, 4 DRAWERS
GPO/2	GENERAL POWER OUTLET - DOUBLE
LS/R	LIGHT SWITCH - ROOM
PDU	PEDESTAL DRAWER UNIT, MOBILE
PRT	PRINTER
TEL	TELEPHONE
WBM	WHITE BOARD - MAGNETIC
WBP	WASTE BIN, PAPER
WSPT&CR	WORKSTATION: PARTITION WITH CABLE RAIL
WSSU	WORKSTATION: SHELVING UNIT
CPT	CARPET TILES
SK7	TIMBER SKIRTING
WPF	WALL PAINT FINISH

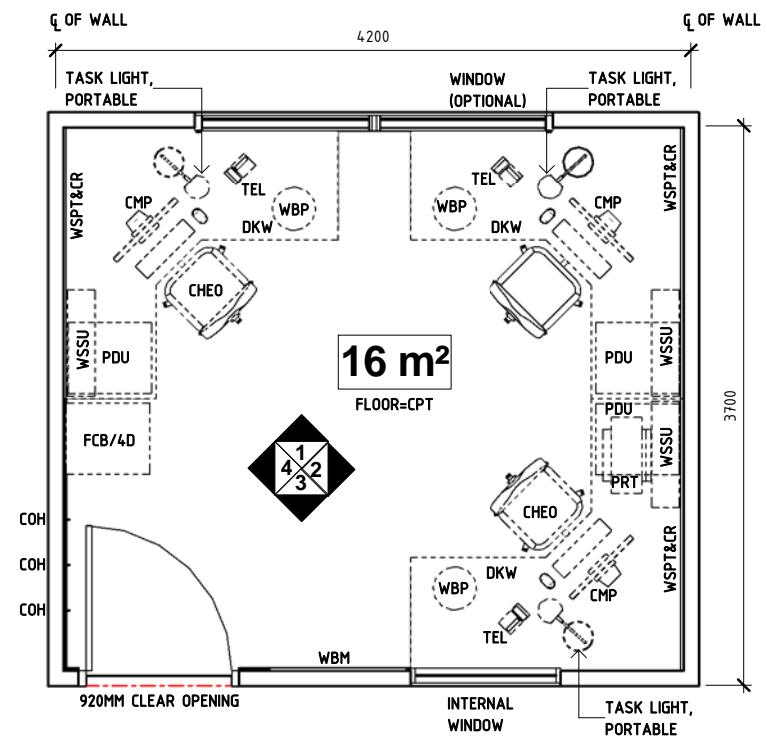

PLAN

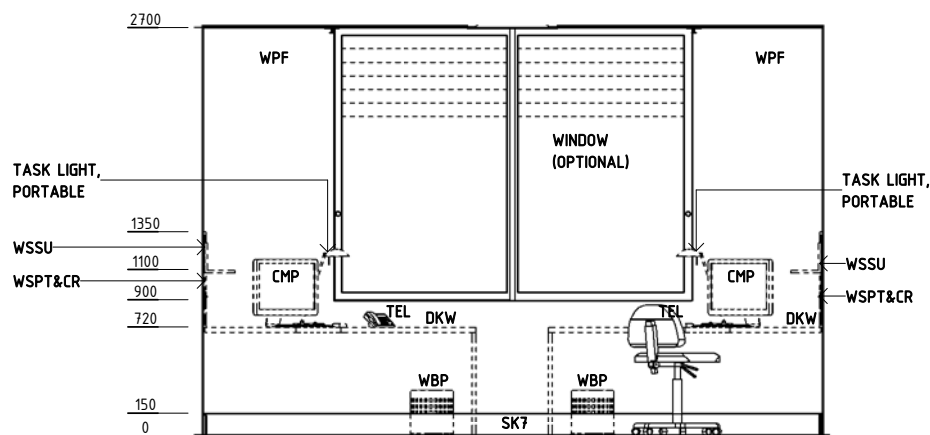

ELEVATION 1

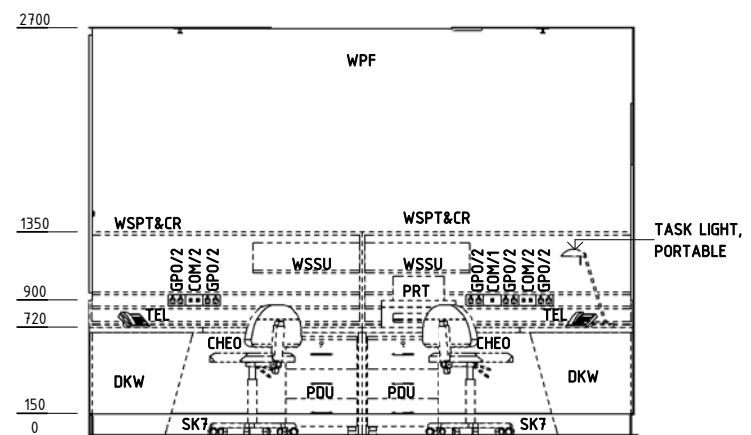

ELEVATION 2

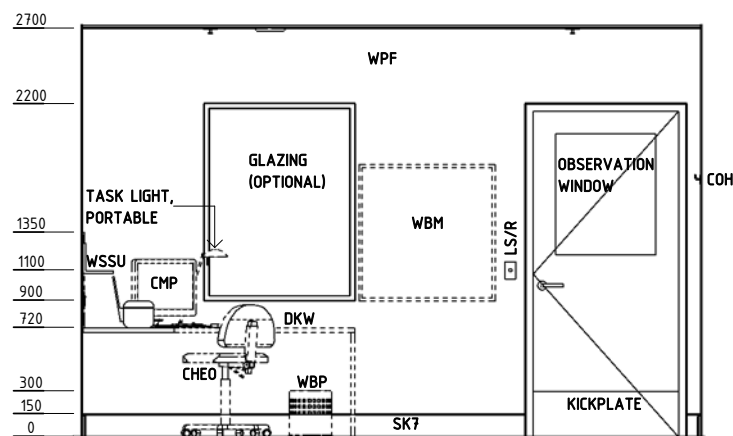

ELEVATION 3

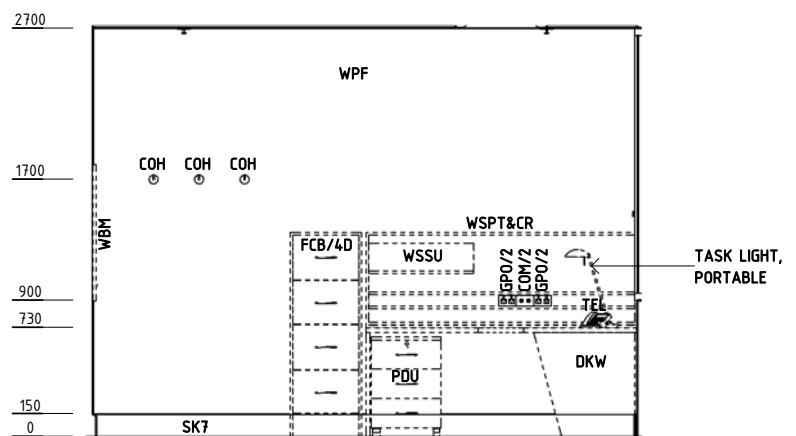

ELEVATION 4

REV	DESCRIPTION	DATE	BY	REV	DESCRIPTION	DATE	BY	REV	DESCRIPTION	DATE	BY
1	FIRST ISSUE #	08.01.2015	NB								

iHFG Standard Components

Room Layout Sheet

Room Name **Office - 3 Person Shared**





RLS Room Code **OFF-3P**
RDS Room Code **OFF-3P**

GENERAL NOTES:

THIS DRAWING TO BE READ IN CONJUNCTION WITH R.D.S. (ROOM DATA SHEETS) WHICH TAKES PRECEDENCE.

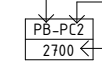
ALL SERVICES INDICATED ARE INDICATIVE AND SUBJECT TO DETAILED PROJECT SPECIFIC ENGINEERING DESIGN.

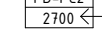

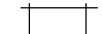
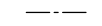
CEILING LEGEND:

-  CEILING TYPE
-  CORNICE TYPE
-  HEIGHT ABOVE F.F.L.
-  ACOUSTIC CEILING TILES WITH POWDERCOAT ALUMINIUM CORNICE, SHADOW ANGLE 24mm
-  TILE CEILING GRID (1200 x 600)
-  GRID LINE

ELECTRICAL LEGEND:

-  FLUORESCENT DIFFUSED RECESSED

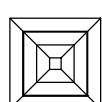
MECHANICAL LEGEND:

-  SUPPLY AIR GRILLE
-  RETURN AIR OR TRANSFER GRILLE

FIRE SERVICES LEGEND:

-  SMOKE DETECTOR
-  SPRINKLER

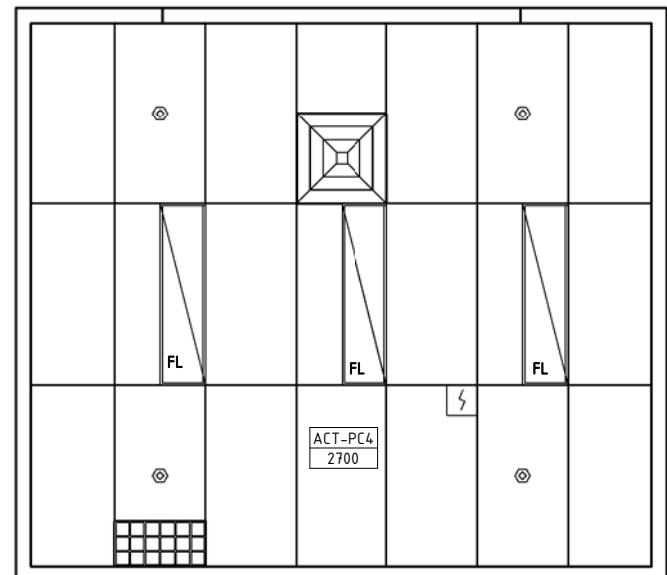

REFLECTED CEILING PLAN

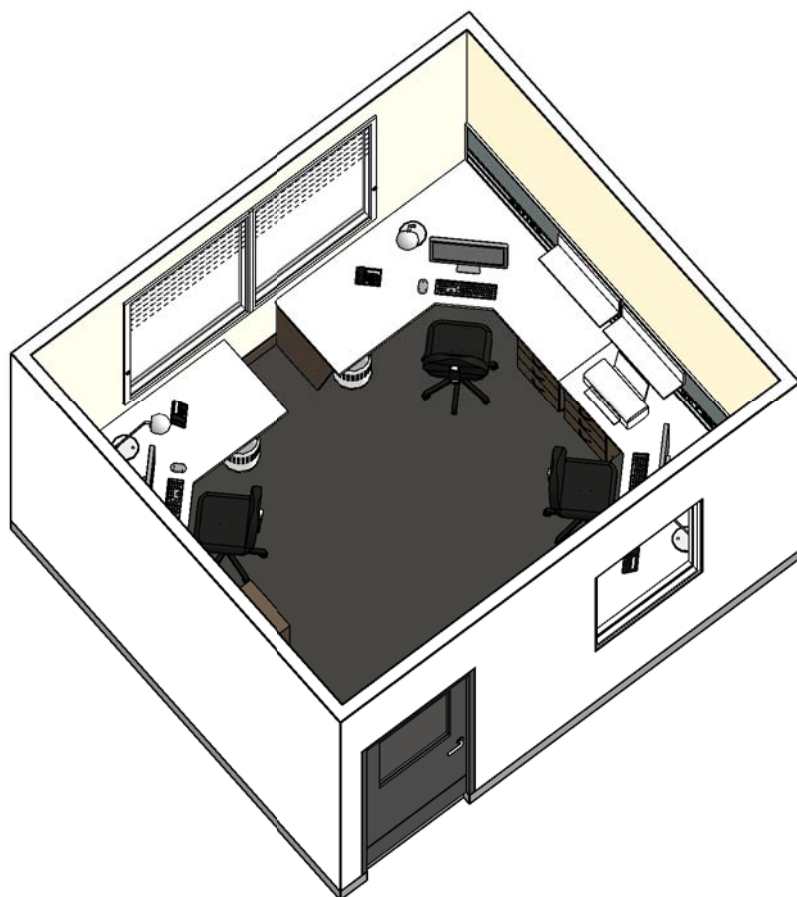

ISOMETRIC VIEW 01

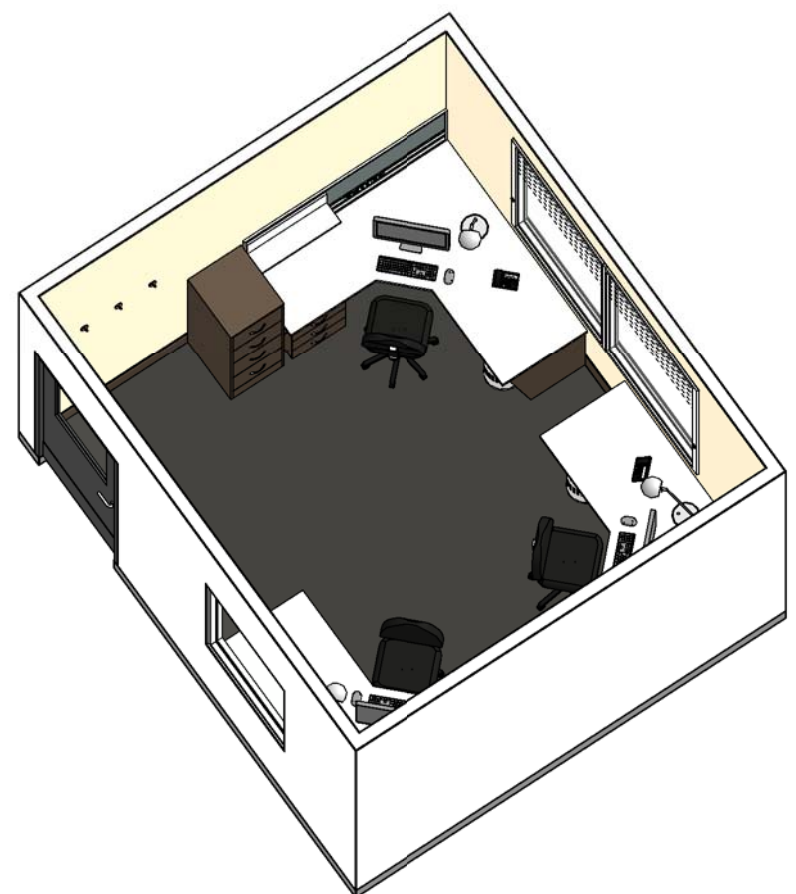

ISOMETRIC VIEW 02

REV	DESCRIPTION	DATE	BY	REV	DESCRIPTION	DATE	BY	REV	DESCRIPTION	DATE	BY
1	FIRST ISSUE #	08.01.2015	NB								

iHFG Standard Components

Room Layout Sheet

Room Name | Office - 3 Person Shared

RLS Room Code OFF-3P-I
RDS Room Code OFF-3P-I



PERSPECTIVE 01

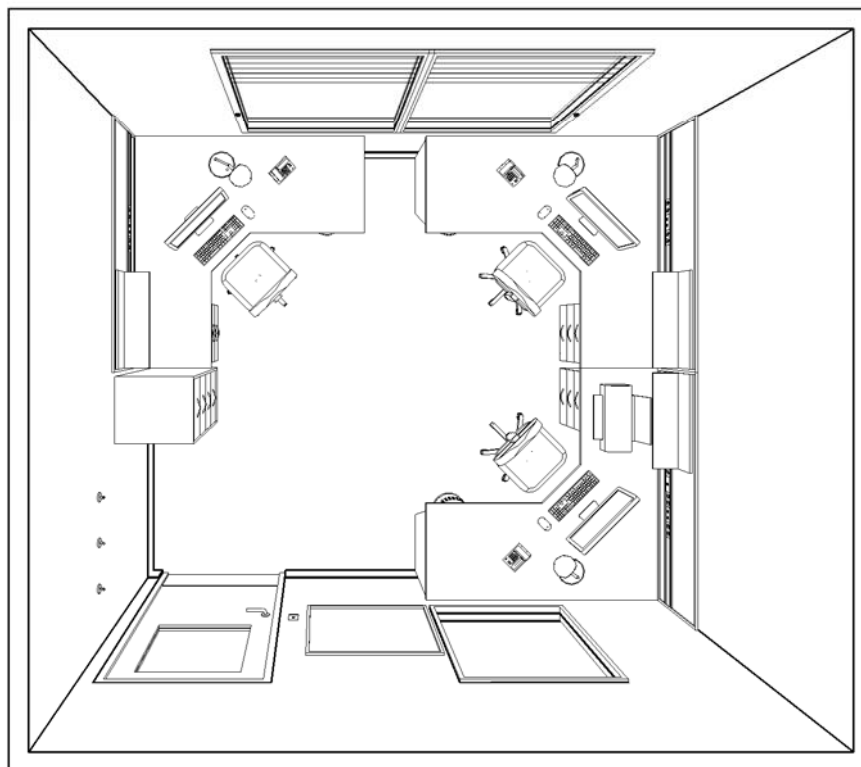

PERSPECTIVE - PLAN VIEW

REV	DESCRIPTION	DATE	BY	REV	DESCRIPTION	DATE	BY	REV	DESCRIPTION	DATE	BY
1	FIRST ISSUE #	08.01.2015	NB								



The International Health Facility Guidelines recommends the use of HFBS “Health Facility Briefing System” to edit all room data sheet information for your project.

HFBS provides edit access to all iHFG standard rooms, and departments, and more than 100 custom report templates.

HFBS Health Facility Briefing System



Briefing Module

The Health Facility Briefing System (HFBS) has numerous modules available via annual subscription. It suits healthcare Architects, Medical Planners, Equipment Planners Project Managers and Health Authorities.

Use the HFBS Briefing Module to quickly drag in health facility departments or pre-configured room templates from the iHFG standard, edit the room features such as finishes, furniture, fittings, fixtures, medical equipment, engineering services. The system can print or download as PDF more than 100 custom reports including room data sheets, schedules, and more...

To learn more about the HFBS web-based Healthcare Briefing and Design Software and to obtain editable versions of the “Standard Components” including Room Data Sheets (RDS) and Room Layout Sheets (RLS) offered on the iHFG website, signup for HFBS using the link below.

Get Started Now:
hfbs.healthdesign.com.au

- ✓ iHFG Room Data Sheets and Departments are instantly editable in the HFBS software available online.
- ✓ You can access hundreds of report templates to print your iHFG room data in HFBS.
- ✓ HFBS has a onetime free 3 day trial available to all new users.

Get Started Now:
hfbs.healthdesign.com.au



HFBS

Health Facility Briefing System

hfbsinfo.com | techsupport@healthdesign.com.au