

iHFG Standard Components

Room Layout Sheet

Room Name **Staff Room, 15m²**

RLS Room Code **SRM-15-I**
RDS Room Code **SRM-15-I**

Abbreviations

| | |
|---------|---|
| BCT-U | BENCHTOP WITH UPTURN |
| BCWU | BOILING / CHILLED WATER UNIT |
| BTV | BRACKET: TV |
| CHD | CHAIR: DINING |
| COM/1 | COMMUNICATION OUTLET - SINGLE |
| COM/2 | COMMUNICATION OUTLET - DOUBLE |
| DHT | DISPENSER - HAND TOWEL |
| DRWU | DRAWER UNIT |
| DS | DISPENSER - SOAP |
| FCPB-AS | FLOOR CUPBOARD WITH ADJUSTABLE SHELVES |
| FG | FRIDGE |
| GPO/1 | GENERAL POWER OUTLET - SINGLE |
| GPO/2 | GENERAL POWER OUTLET - DOUBLE |
| LS/R | LIGHT SWITCH - ROOM |
| MATV | MASTER ANTENNA TV |
| OMW | OVEN: MICROWAVE |
| PB/F | PIN BOARD, FABRIC COVERED |
| RKM | RACK: MAGAZINE |
| SBK | SPLASHBACK |
| SNKD | SINK WITH DRAINER, STAINLESS STEEL |
| SUM-AS | SHELVING UNIT: MICROWAVE, WITH ADJUSTABLE SHELF |
| TBCH | TAPWARE: BOILING / CHILLED |
| TDN | TABLE: DINING |
| TLW | TABLE: LOW |
| TMSL | TAP MIXER, SINGLE LEVER |
| TV | TELEVISION SET |
| WBIN | WASTE BIN |
| WBM | WHITE BOARD - MAGNETIC |
| WCPD-AS | WALL CUPBOARD WITH ADJUSTABLE SHELVES |
| WT | TELEPHONE WALL MOUNTED |
| PBB | PLASTERBOARD BULKHEAD, PAINT FINISH |
| SK7 | TIMBER SKIRTING |
| WPF | WALL PAINT FINISH |
| CPT | CARPET TILES |
| V1 | VINYL FLOORING, STANDARD SLIP RESISTANT |

NOTE:
A STAFF LOUNGE IN ADMINISTRATION AREA SHOULD INCLUDE A HANDWASH STATION.

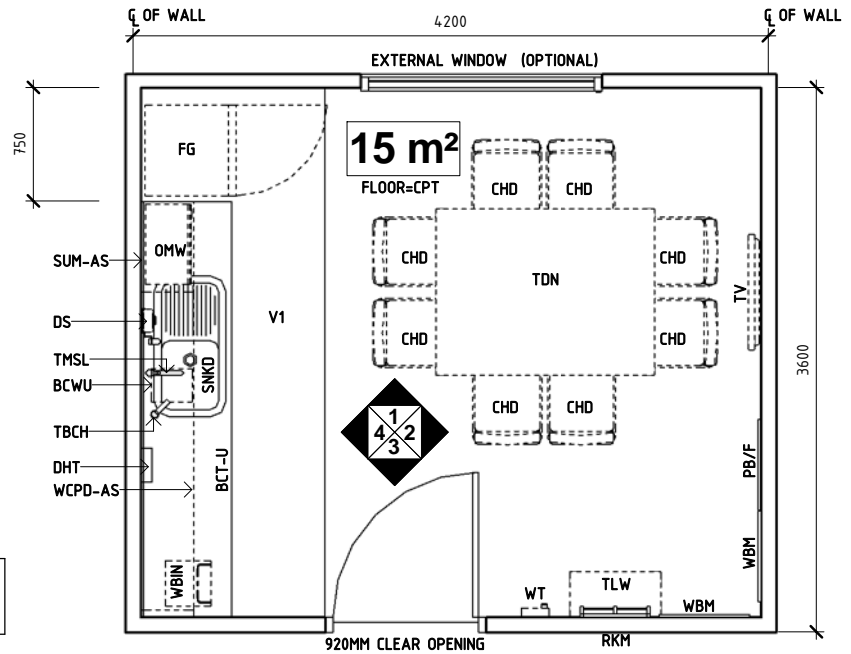

PLAN

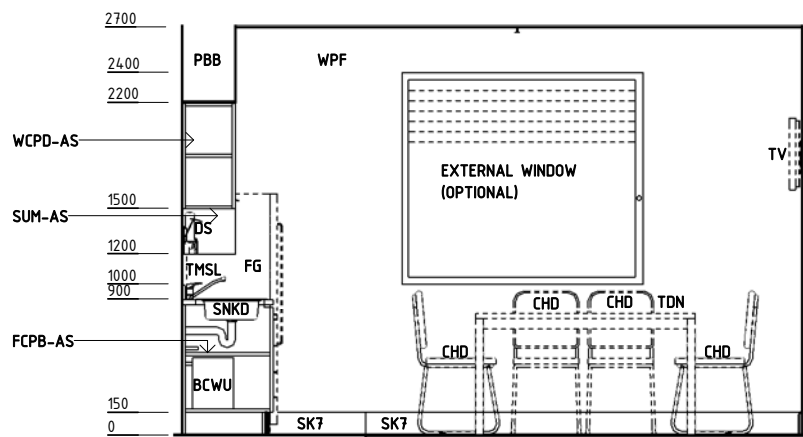

ELEVATION 1

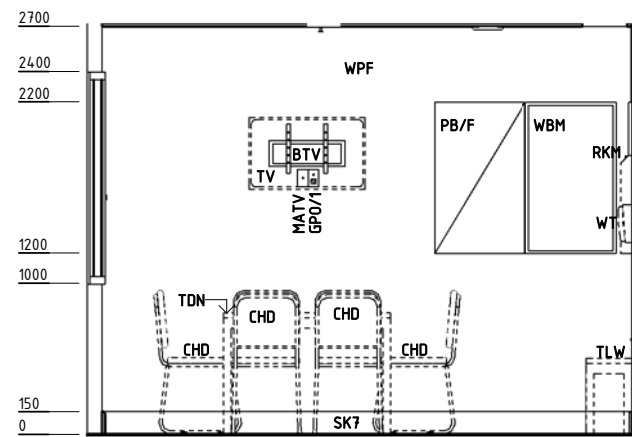

ELEVATION 2

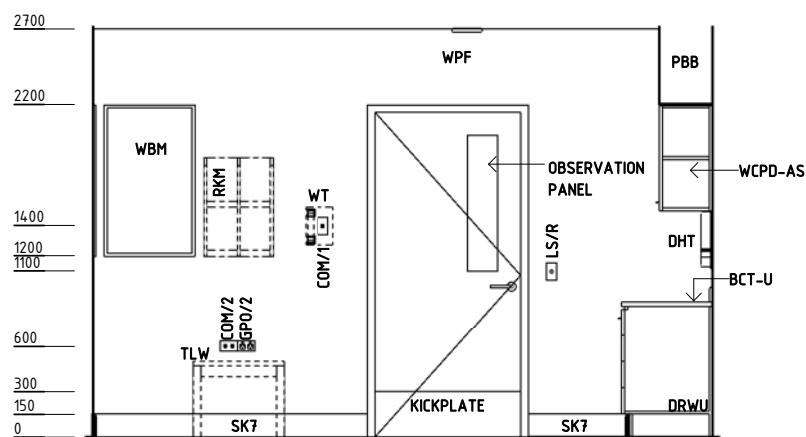

ELEVATION 3

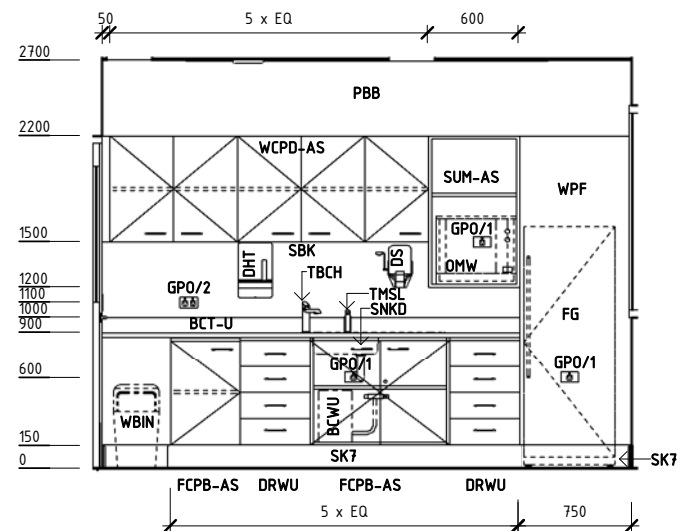

ELEVATION 4

| REV | DESCRIPTION | DATE | BY | REV | DESCRIPTION | DATE | BY | REV | DESCRIPTION | DATE | BY |
|-----|------------------|------------|----|-----|-------------|------|----|-----|-------------|------|----|
| 1 | FIRST ISSUE # | 29.08.2014 | NB | | | | | | | | |
| 2 | GENERAL REVISION | 07.01.2015 | NB | | | | | | | | |

iHFG Standard Components

Room Layout Sheet

Room Name **Staff Room, 15m²**

RLS Room Code **SRM-15-I**
RDS Room Code **SRM-15-I**

GENERAL NOTES:

THIS DRAWING TO BE READ IN CONJUNCTION WITH R.D.S. (ROOM DATA SHEETS) WHICH TAKES PRECEDENCE.

ALL SERVICES INDICATED ARE INDICATIVE AND SUBJECT TO DETAILED PROJECT SPECIFIC ENGINEERING DESIGN.

CEILING LEGEND:

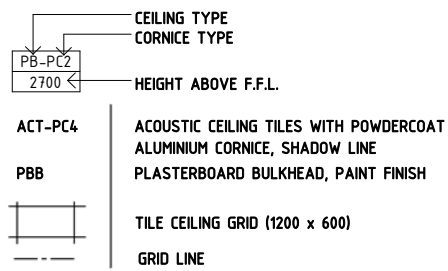

ELECTRICAL LEGEND:



MECHANICAL LEGEND:

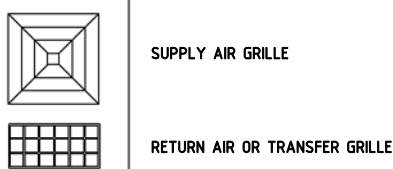

FIRE SERVICES LEGEND:

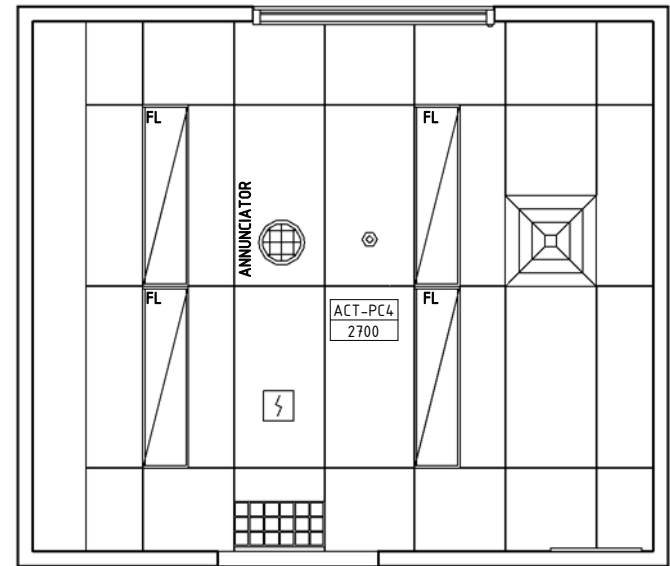

REFLECTED CEILING PLAN

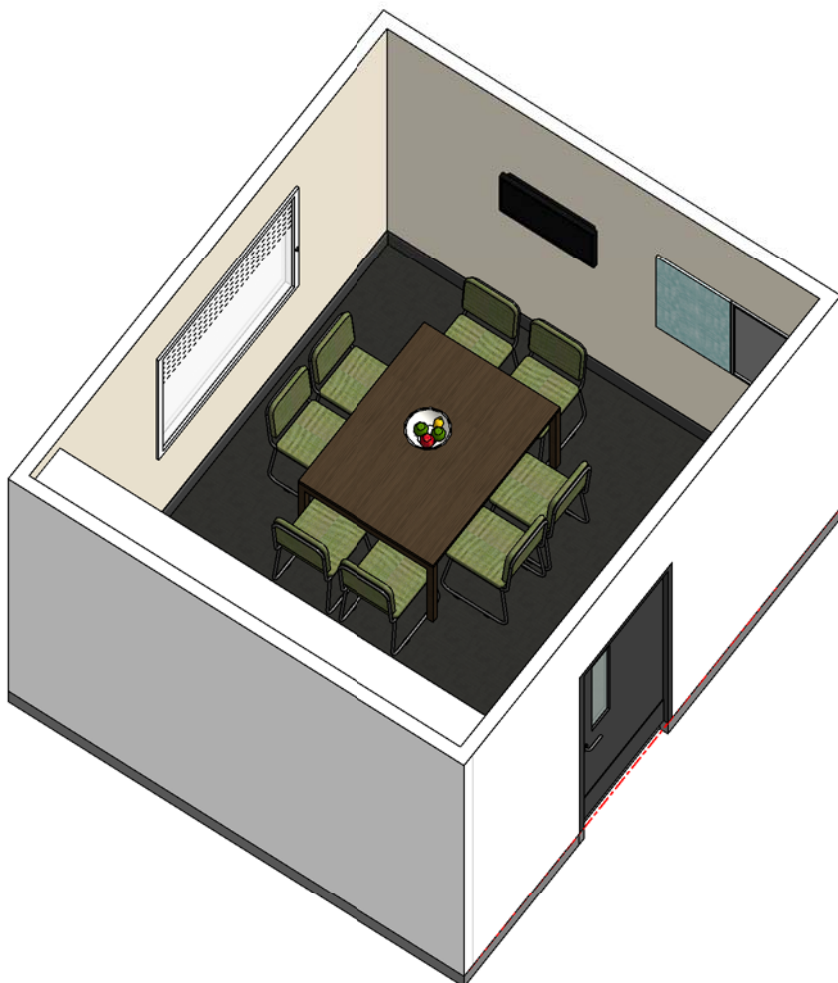

ISOMETRIC VIEW 01



ISOMETRIC VIEW 02

| REV | DESCRIPTION | DATE | BY | REV | DESCRIPTION | DATE | BY | REV | DESCRIPTION | DATE | BY |
|-----|------------------|------------|----|-----|-------------|------|----|-----|-------------|------|----|
| 1 | FIRST ISSUE # | 29.08.2014 | NB | | | | | | | | |
| 2 | GENERAL REVISION | 07.01.2015 | NB | | | | | | | | |

iHFG Standard Components

Room Layout Sheet

Room Name | Staff Room, 15m²

RLS Room Code SRM-15-I
RDS Room Code SRM-15-I



PERSPECTIVE 01

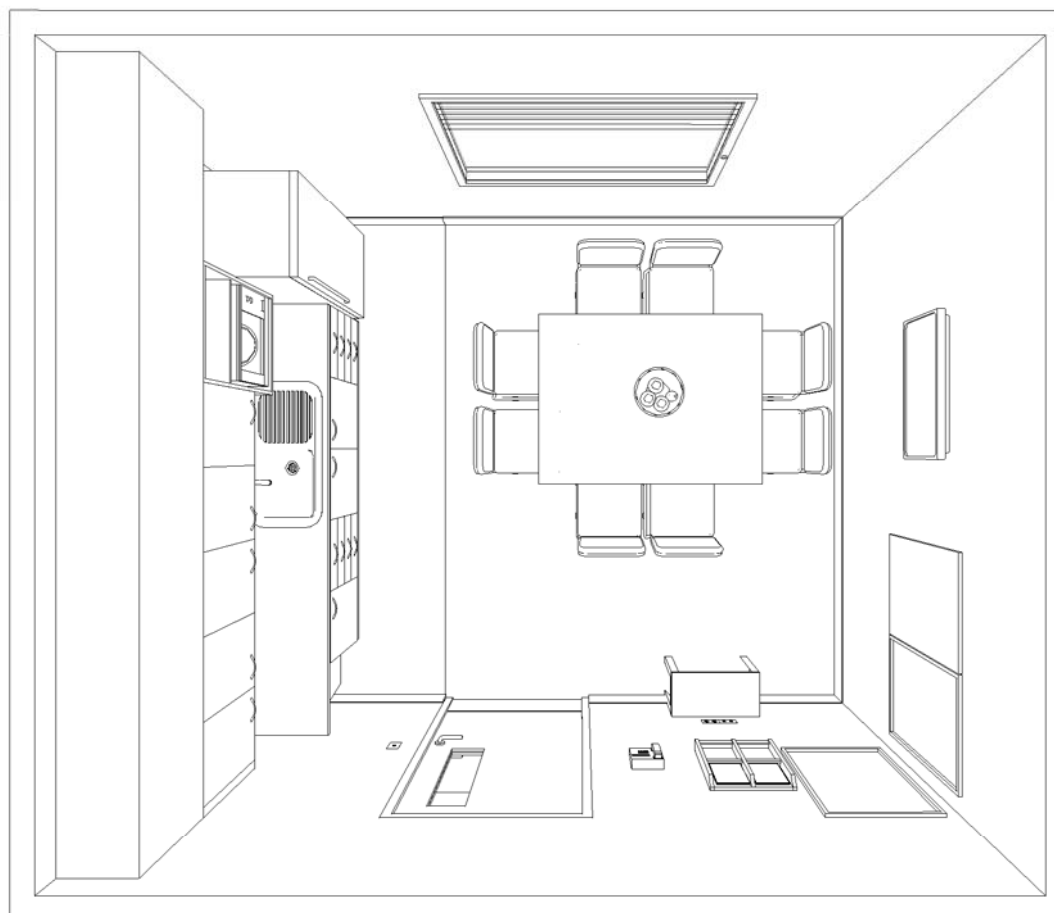

PERSPECTIVE - PLAN VIEW

| REV | DESCRIPTION | DATE | BY | REV | DESCRIPTION | DATE | BY | REV | DESCRIPTION | DATE | BY |
|-----|------------------|------------|----|-----|-------------|------|----|-----|-------------|------|----|
| 1 | FIRST ISSUE # | 29.08.2014 | NB | | | | | | | | |
| 2 | GENERAL REVISION | 07.01.2015 | NB | | | | | | | | |



The International Health Facility Guidelines recommends the use of HFBS “Health Facility Briefing System” to edit all room data sheet information for your project.

HFBS provides edit access to all iHFG standard rooms, and departments, and more than 100 custom report templates.

HFBS Health Facility Briefing System



Briefing Module

The Health Facility Briefing System (HFBS) has numerous modules available via annual subscription. It suits healthcare Architects, Medical Planners, Equipment Planners Project Managers and Health Authorities.

Use the HFBS Briefing Module to quickly drag in health facility departments or pre-configured room templates from the iHFG standard, edit the room features such as finishes, furniture, fittings, fixtures, medical equipment, engineering services. The system can print or download as PDF more than 100 custom reports including room data sheets, schedules, and more...

To learn more about the HFBS web-based Healthcare Briefing and Design Software and to obtain editable versions of the “Standard Components” including Room Data Sheets (RDS) and Room Layout Sheets (RLS) offered on the iHFG website, signup for HFBS using the link below.

Get Started Now:
hfbs.healthdesign.com.au

- ✓ iHFG Room Data Sheets and Departments are instantly editable in the HFBS software available online.
- ✓ You can access hundreds of report templates to print your iHFG room data in HFBS.
- ✓ HFBS has a onetime free 3 day trial available to all new users.

Get Started Now:
hfbs.healthdesign.com.au



HFBS

Health Facility Briefing System

hfbsinfo.com | techsupport@healthdesign.com.au