

iHFG Standard Components

Room Layout Sheet

Room Name **Clean Utility / Medication, 14m² (Manual Dispensing)**

RLS Room Code **CLUM-14-A-I**
RDS Room Code **CLUM-14-I**

Abbreviations

ALD	DURESS ALARM
ANC	ANNUNCIATOR
BCT	BENCHTOP
BCT-U	BENCHTOP WITH UPTURN
BSB	BRACKET: SHARP BIN
COM/1	COMMUNICATION OUTLET - SINGLE
COM/2	COMMUNICATION OUTLET - DOUBLE
CPDPM	CUPBOARD: PHARMACY MANAGEMENT, LOCKABLE
CRA	CARD ACCESS
DAHR	DISPENSER - ANTISEPTIC HAND RUB
DDG	DISPENSER - DISPOSABLE GLOVES
DFP	DOOR AND DOOR FRAME PROTECTION
DHT	DISPENSER - HAND TOWEL
DMS	DISPENSER - MOISTURISER
DS	DISPENSER - SOAP
DSA	DISPENSER - SOAP ANTISEPTIC
FCPB-AS	FLOOR CUPBOARD WITH ADJUSTABLE SHELVES
FGDS	FRIDGE: DRUG, SMALL
FSHU	FLOOR SHELVING UNIT
GPO/1	GENERAL POWER OUTLET - SINGLE
GPO/1EP	EMERGENCY POWER OUTLET - SINGLE
HW-B	HAND WASH BASIN, TYPE'B'
LS/P	LIGHT SWITCH - PELMET TASK LIGHT
LS/R2	LIGHT SWITCH - ROOM, 2 WAY
LVP	LOUVRED PANEL
RB	RETURN BIN
SBIN	SHARPS BINS
SDDM	SAFE : DANGEROUS DRUG MEDIUM
SNK	SINK, STAINLESS STEEL, 450X350X250D
ST	SENSOR TAP
STB	STORAGE BIN
SUFH-AHDS	SHELVING UNIT, FULL HEIGHT, WITH ADJUSTABLE HEAVY DUTY SHELVES
TDR	TROLLEY: DRESSING
TM	TROLLEY MEDICATION
TMA	TEMPERATURE MONITOR & ALARM
TMSL	TAP MIXER, SINGLE LEVER
WBP	WASTE BIN, PAPER
WCPD-AS	WALL CUPBOARD WIDTH ADJUSTABLE SHELVES
WCPD-AS-FGD	WALL CUPBOARD WITH ADJUSTABLE SHELVES, FRAMED GLASS DOOR, LOCKABLE
WSU-AS	WALL SHELVING UNIT WITH ADJUSTABLE SHELVES
PBB	PLASTERBOARD BULKHEAD, PAINT FINISH
SK4	FLOOR VINYL COVERED SKIRTING
WPF	WALL PAINT FINISH
WV	WALL VINYL
V1	VINYL FLOORING, STANDARD SLIP RESISTANT
V6	VINYL FLOORING, NON-SLIP

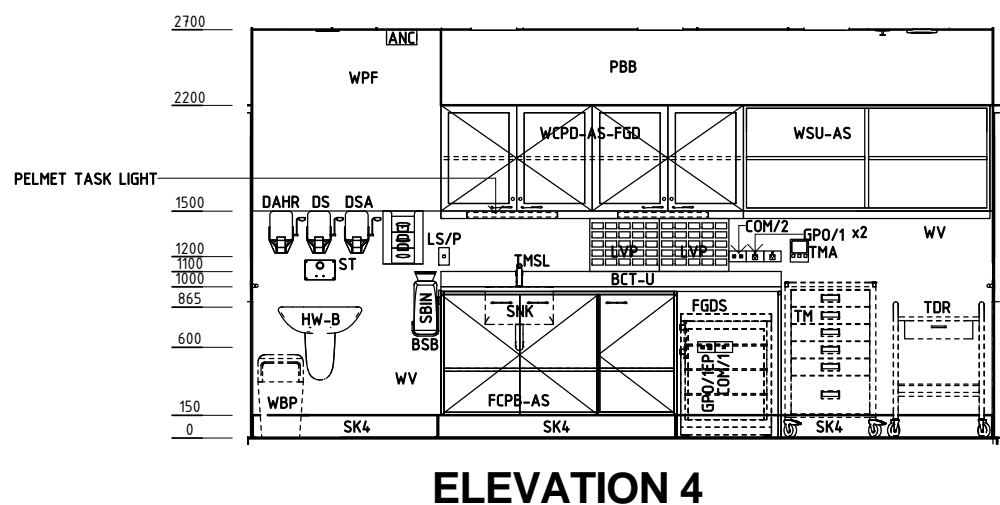
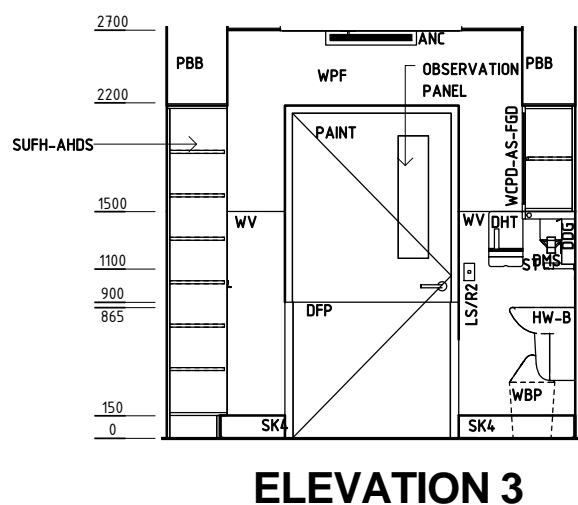
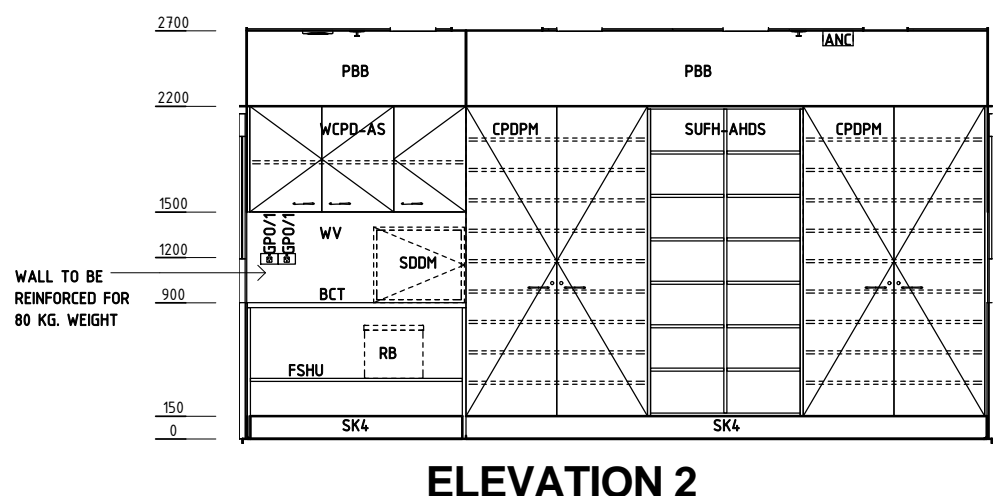
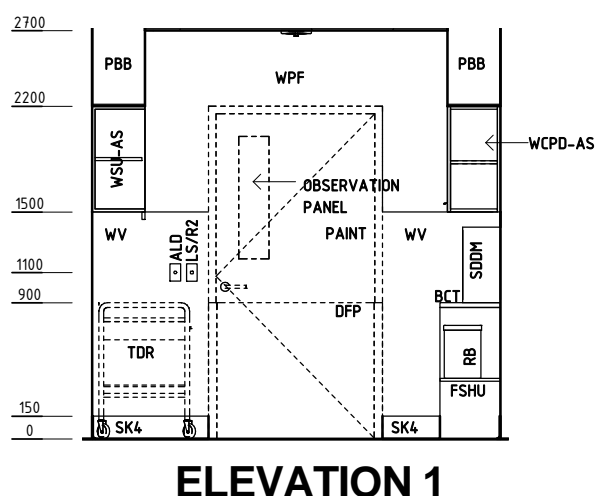
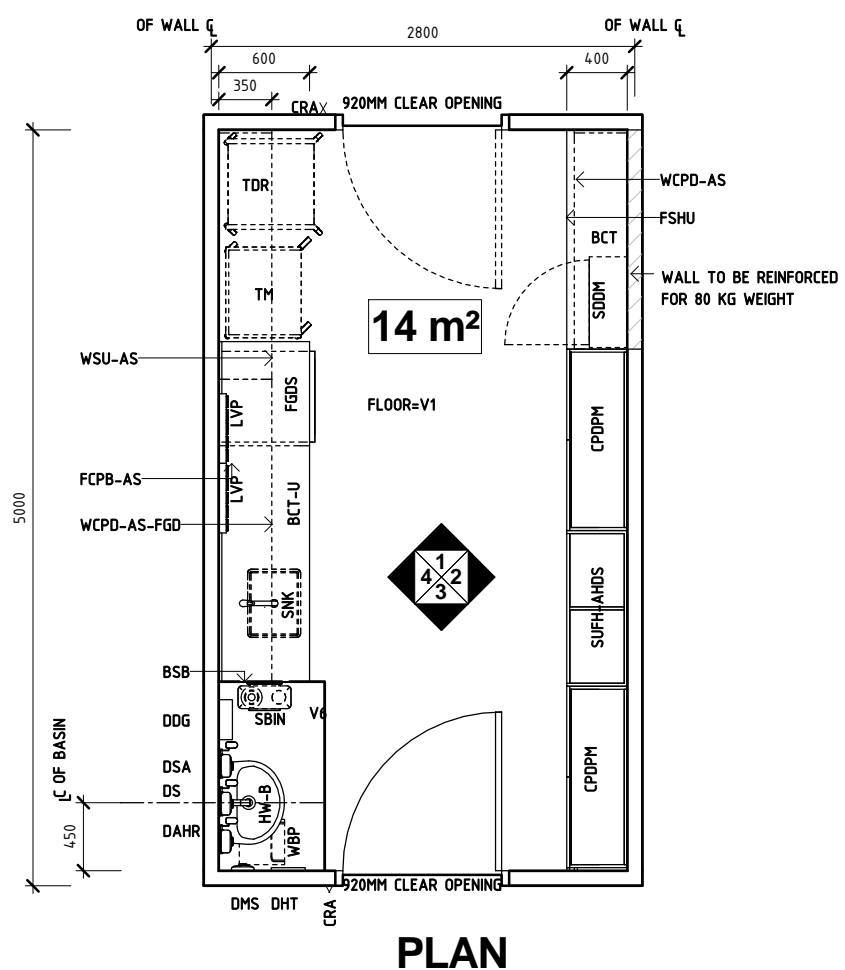

REV	DESCRIPTION	DATE	BY	REV	DESCRIPTION	DATE	BY	REV	DESCRIPTION	DATE	BY
1	FIRST ISSUE #	29.08.2014	NB								
2	GENERAL REVISION	07.01.2015	NB								

iHFG Standard Components

Room Layout Sheet

Room Name **Clean Utility / Medication, 14m² (Manual Dispensing)**

RLS Room Code **CLUM-14-A-I**
RDS Room Code **CLUM-14-I**

GENERAL NOTES:

THIS DRAWING TO BE READ IN CONJUNCTION WITH R.D.S. (ROOM DATA SHEETS) WHICH TAKES PRECEDENCE.

ALL SERVICES INDICATED ARE INDICATIVE AND SUBJECT TO DETAILED PROJECT SPECIFIC ENGINEERING DESIGN.

CEILING LEGEND:

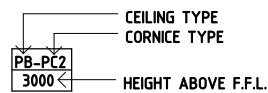

PB-PC4 PLASTERBOARD FLUSH SET CEILING, PAINT FINISH WITH POWDERCOAT ALUMINIUM CORNICE, SHADOW LINE
PBB PLASTERBOARD BULKHEAD, PAINT FINISH
--- GRID LINE

ELECTRICAL LEGEND:

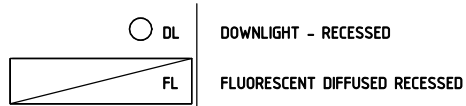

MECHANICAL LEGEND:

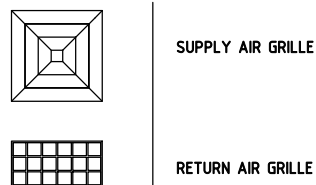

FIRE SERVICES LEGEND:

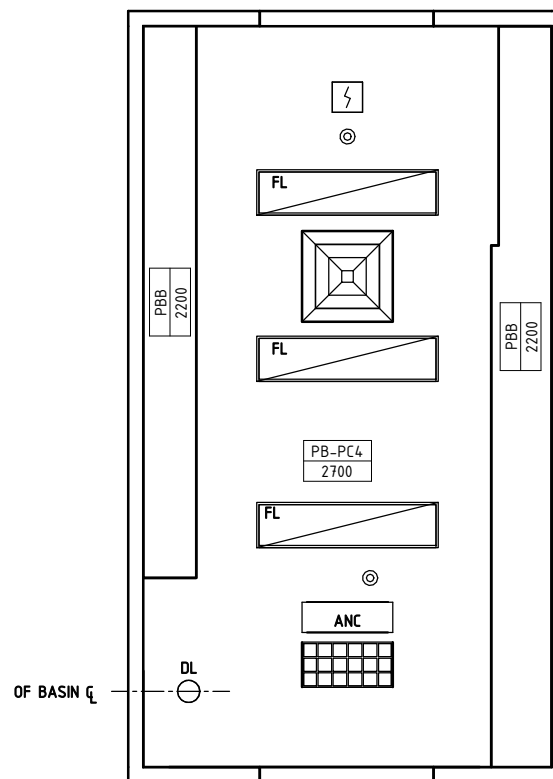
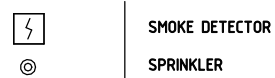

REFLECTED CEILING PLAN

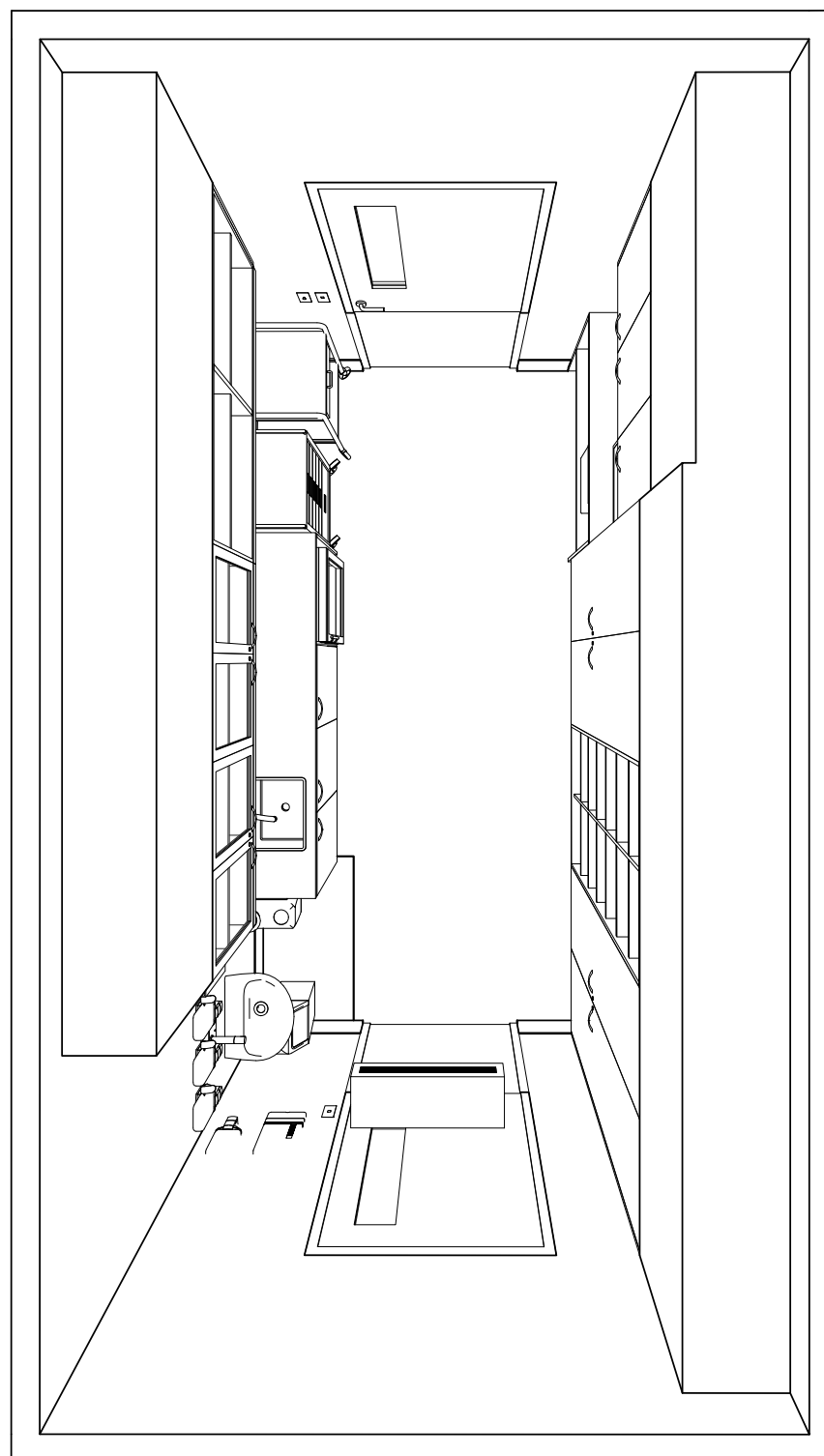

PERSPECTIVE - PLAN VIEW

REV	DESCRIPTION	DATE	BY	REV	DESCRIPTION	DATE	BY	REV	DESCRIPTION	DATE	BY
1	FIRST ISSUE #	29.08.2014	NB								
2	GENERAL REVISION	07.01.2015	NB								

iHFG Standard Components

Room Layout Sheet

Room Name | Clean Utility / Medication, 14m² (Manual Dispensing)

RLS Room Code CLUM-14-A-I
RDS Room Code CLUM-14-I



PERSPECTIVE 01

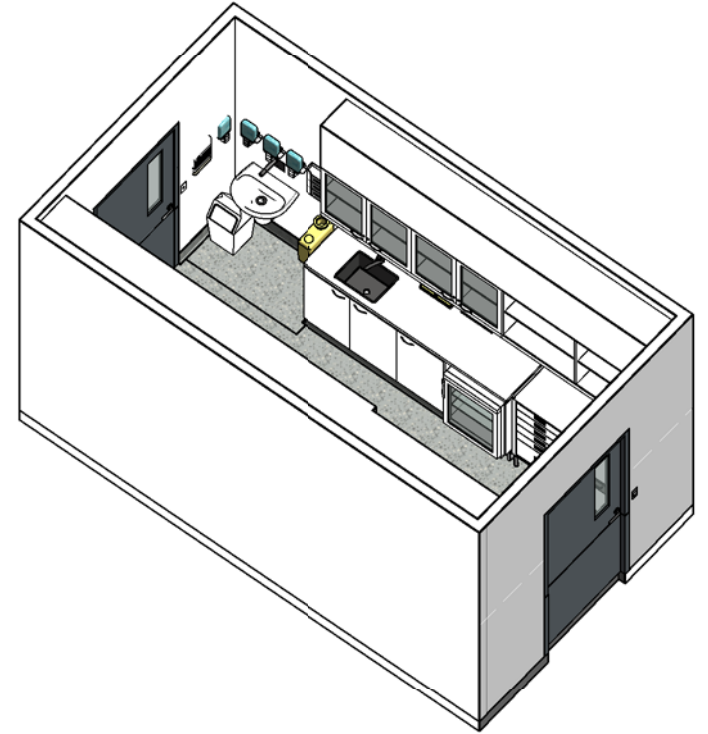

ISOMETRIC VIEW 01



PERSPECTIVE 02

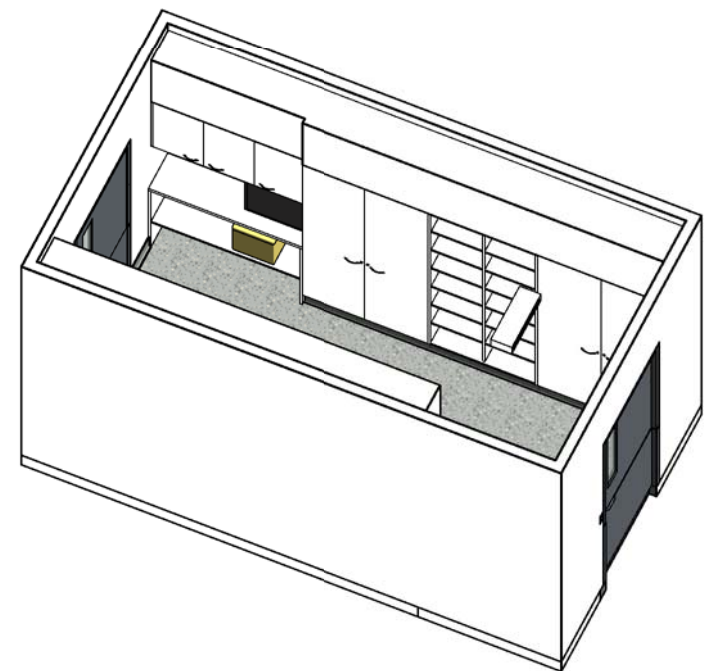

ISOMETRIC VIEW 02

REV	DESCRIPTION	DATE	BY	REV	DESCRIPTION	DATE	BY	REV	DESCRIPTION	DATE	BY
1	FIRST ISSUE #	29.08.2014	NB								
2	GENERAL REVISION	07.01.2015	NB								

iHFG Standard Components

Room Layout Sheet

Room Name **Clean Utility / Medication, 14m² (Automated Dispensing)**

RLS Room Code **CLUM-14-B-I**
RDS Room Code **CLUM-14-I**

Abbreviations

ALD	DURESS ALARM
AMMD	AUTOMATED MEDICATION MANAGEMENT DEVICE
ANC	ANNUNCIATOR
BCT-U	BENCHTOP WITH UPTURN
BSB	BRACKET: SHARP BIN
COM/1	COMMUNICATION OUTLET - SINGLE
COM/2	COMMUNICATION OUTLET - DOUBLE
CPDPM	CUPBOARD: PHARMACY MANAGEMENT, LOCKABLE
CRA	CARD ACCESS
DAHR	DISPENSER - ANTISEPTIC HAND RUB
DDG	DISPENSER - DISPOSABLE GLOVES
DFP	DOOR AND DOOR FRAME PROTECTION
DHT	DISPENSER - HAND TOWEL
DMS	DISPENSER - MOISTURISER
DS	DISPENSER - SOAP
DSA	DISPENSER - SOAP ANTISEPTIC
FCPB-AS	FLOOR CUPBOARD WITH ADJUSTABLE SHELVES
FGDS	FRIDGE: DRUG, SMALL
GPO/1	GENERAL POWER OUTLET - SINGLE
GPO/1EP	EMERGENCY POWER OUTLET - SINGLE
GPO/2EP	EMERGENCY POWER OUTLET - DOUBLE
HW-B	HAND WASH BASIN, TYPE 'B'
LS/P	LIGHT SWITCH - PELMET TASK LIGHT
LS/R2	LIGHT SWITCH - ROOM, 2 WAY
LVP	LOUVRED PANEL
RB	RETURN BIN
SBIN	SHARPS BINS
SNK	SINK, STAINLESS STEEL, 450X350X250D
ST	SENSOR TAP
STB	STORAGE BIN
SUFH-AHDS	SHELVING UNIT, FULL HEIGHT, WITH ADJUSTABLE HEAVY DUTY SHELVES
TAMD	TROLLEY: AUTOMATED MEDICATION DISPENSING
TDR	TROLLEY: DRESSING
TMA	TEMPERATURE MONITOR & ALARM
TMSL	TAP MIXER, SINGLE LEVER
WBP	WASTE BIN, PAPER
WCPD-AS-FGD	WALL CUPBOARD WITH ADJUSTABLE SHELVES, FRAMED GLASS DOOR, LOCKABLE
PBB	PLASTERBOARD BULKHEAD, PAINT FINISH
SK4	FLOOR VINYL COVED SKIRTING
WPF	WALL PAINT FINISH
WV	WALL VINYL
V1	VINYL FLOORING, STANDARD SLIP RESISTANT
V6	VINYL FLOORING, NON-SLIP

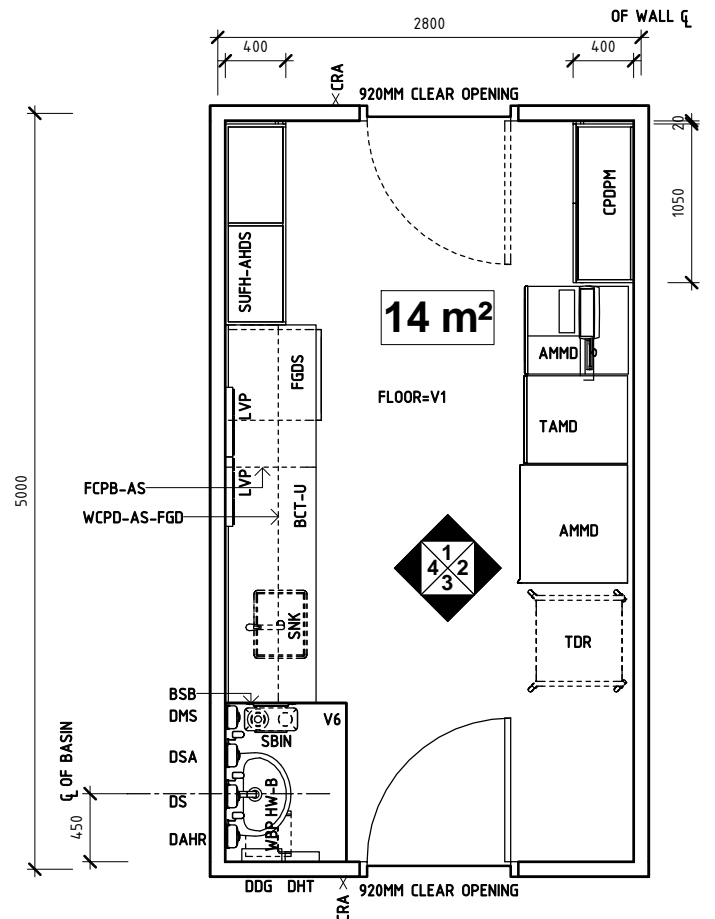

PLAN

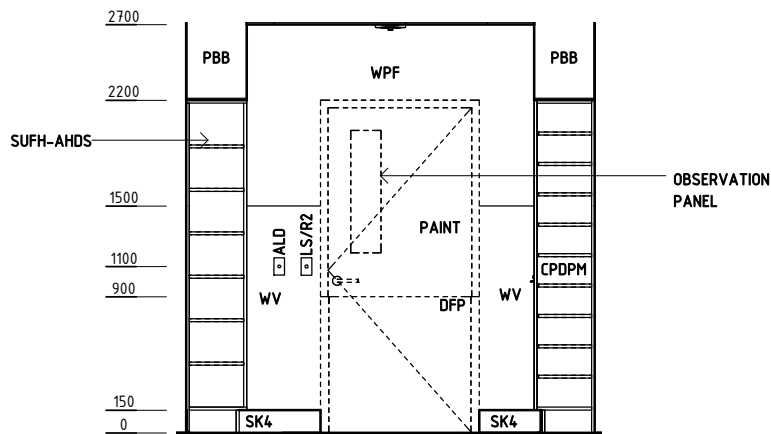

ELEVATION 1

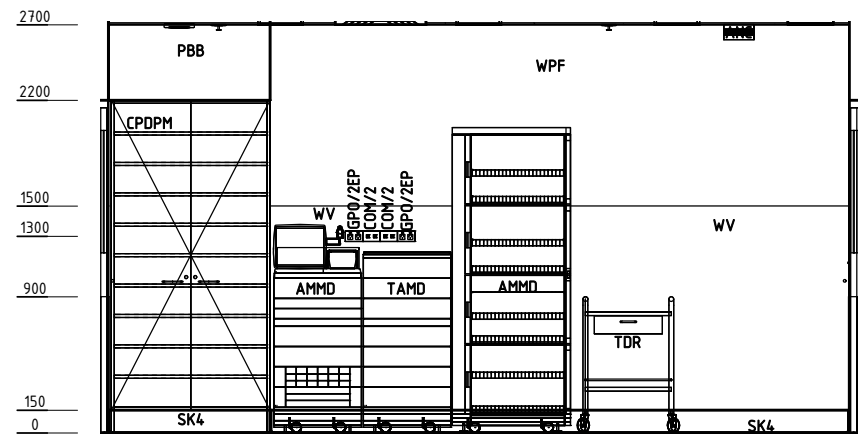

ELEVATION 2

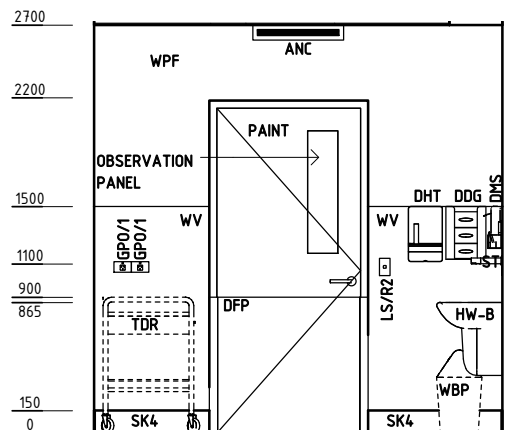

ELEVATION 3

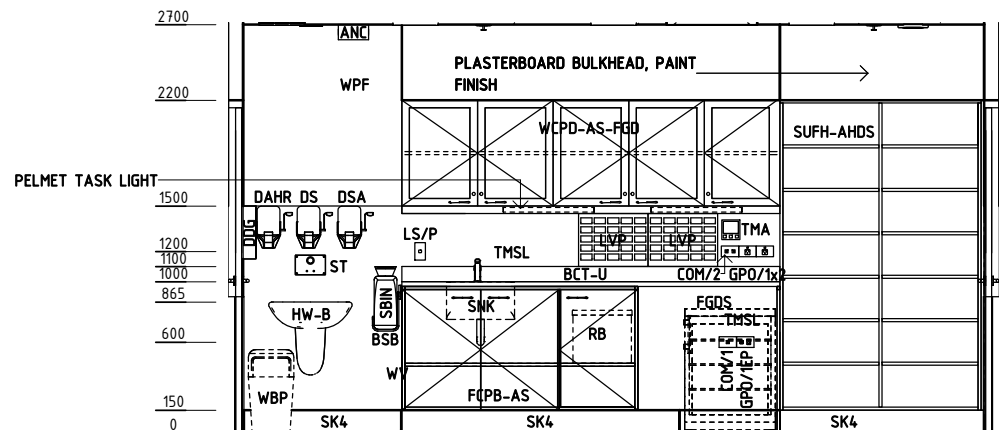

ELEVATION 4

REV	DESCRIPTION	DATE	BY	REV	DESCRIPTION	DATE	BY	REV	DESCRIPTION	DATE	BY
1	FIRST ISSUE #	29.08.2014	NB								
2	GENERAL REVISION	07.01.2015	NB								

iHFG Standard Components

Room Layout Sheet

Room Name **Clean Utility / Medication, 14m² (Automated Dispensing)**

RLS Room Code **CLUM-14-B-I**
RDS Room Code **CLUM-14-I**

GENERAL NOTES:

THIS DRAWING TO BE READ IN CONJUNCTION WITH R.D.S. (ROOM DATA SHEETS) WHICH TAKES PRECEDENCE.

ALL SERVICES INDICATED ARE INDICATIVE AND SUBJECT TO DETAILED PROJECT SPECIFIC ENGINEERING DESIGN.

CEILING LEGEND:

CEILING TYPE
CORNICE TYPE
BP-PC2
2700 ← HEIGHT ABOVE F.F.L.
PB-PC4 PLASTERBOARD FLUSH SET CEILING, PAINT FINISH WITH POWDERCOAT ALUMINIUM CORNICE, SHADOW LINE
PBB PLASTERBOARD BULKHEAD, PAINT FINISH
--- GRID LINE

ELECTRICAL LEGEND:

DL DOWNLIGHT - RECESSED
FL FLUORESCENT DIFFUSED RECESSED

MECHANICAL LEGEND:

SUPPLY AIR GRILLE
RETURN AIR GRILLE

FIRE SERVICES LEGEND:

SMOKE DETECTOR
SPRINKLER

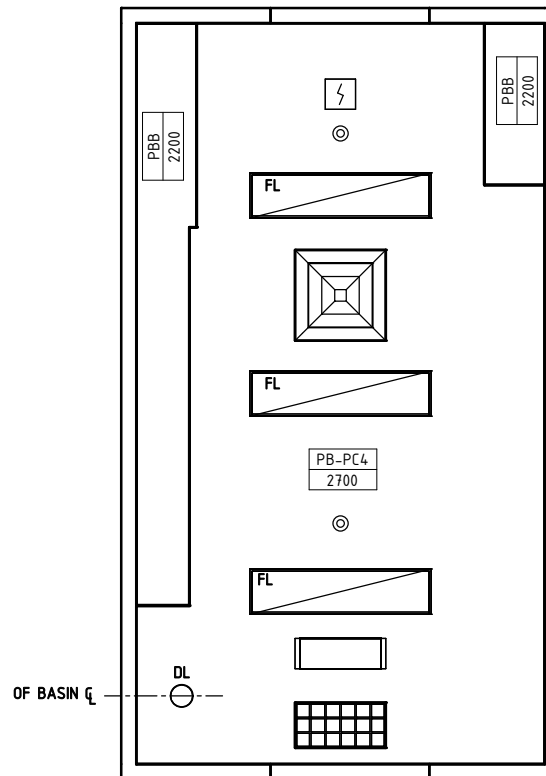

REFLECTED CEILING PLAN

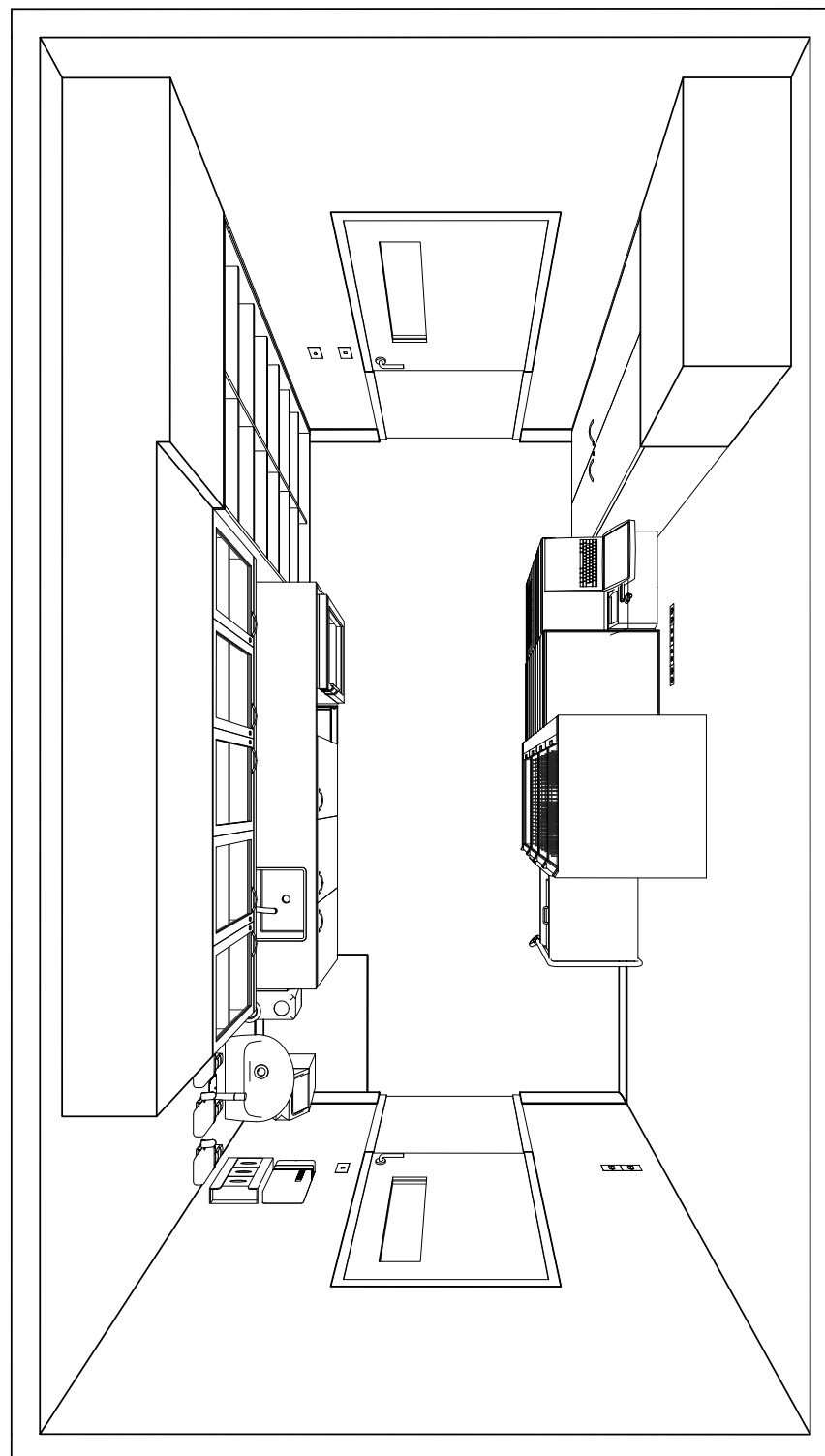

PERSPECTIVE - PLAN VIEW

REV	DESCRIPTION	DATE	BY	REV	DESCRIPTION	DATE	BY	REV	DESCRIPTION	DATE	BY
1	FIRST ISSUE #	29.08.2014	NB								
2	GENERAL REVISION	07.01.2015	NB								

iHFG Standard Components

Room Layout Sheet

Room Name | **Clean Utility / Medication, 14m² (Automated Dispensing)**

RLS Room Code **CLUM-14-B-I**
RDS Room Code **CLUM-14-I**



PERSPECTIVE 01

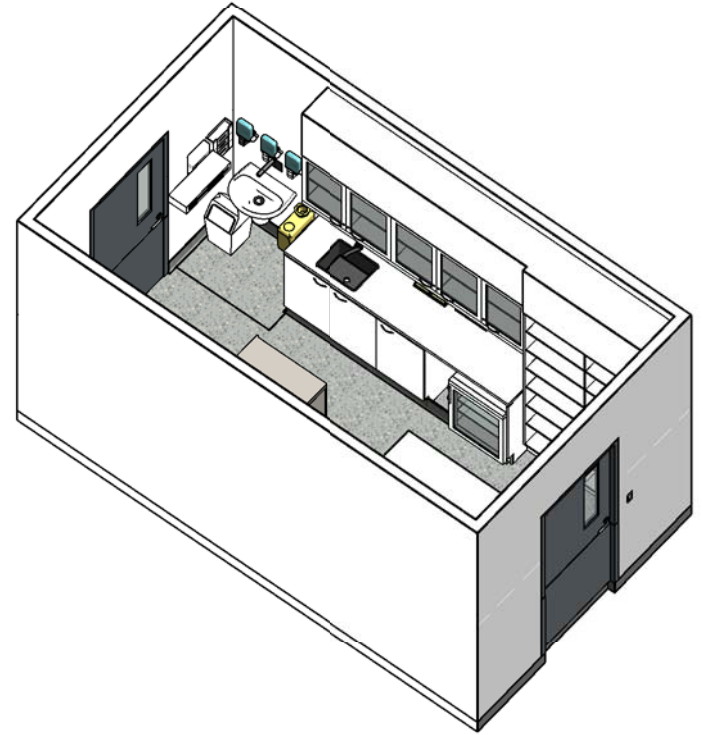

ISOMETRIC VIEW 01



PERSPECTIVE 02

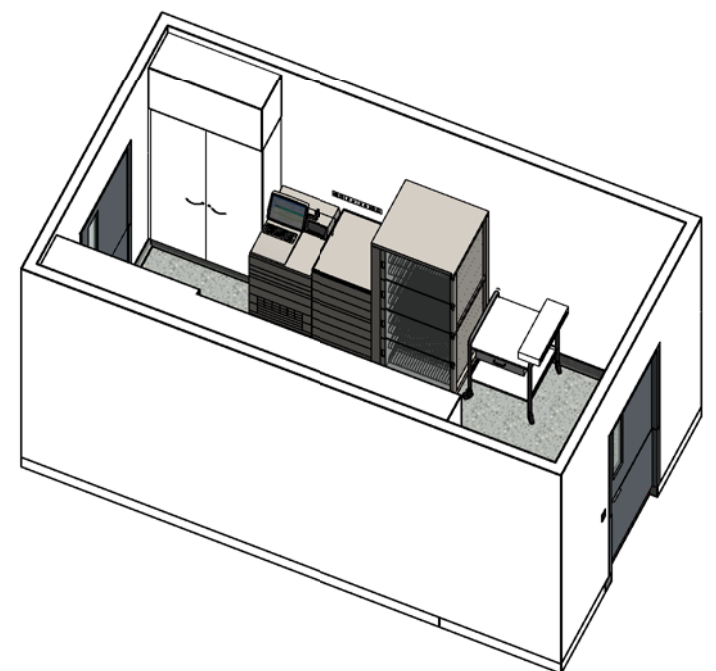

ISOMETRIC VIEW 02

REV	DESCRIPTION	DATE	BY	REV	DESCRIPTION	DATE	BY	REV	DESCRIPTION	DATE	BY
1	FIRST ISSUE #	29.08.2014	NB								
2	GENERAL REVISION	07.01.2015	NB								



The International Health Facility Guidelines recommends the use of HFBS “Health Facility Briefing System” to edit all room data sheet information for your project.

HFBS provides edit access to all iHFG standard rooms, and departments, and more than 100 custom report templates.

HFBS Health Facility Briefing System



Briefing Module

The Health Facility Briefing System (HFBS) has numerous modules available via annual subscription. It suits healthcare Architects, Medical Planners, Equipment Planners Project Managers and Health Authorities.

Use the HFBS Briefing Module to quickly drag in health facility departments or pre-configured room templates from the iHFG standard, edit the room features such as finishes, furniture, fittings, fixtures, medical equipment, engineering services. The system can print or download as PDF more than 100 custom reports including room data sheets, schedules, and more...

To learn more about the HFBS web-based Healthcare Briefing and Design Software and to obtain editable versions of the “Standard Components” including Room Data Sheets (RDS) and Room Layout Sheets (RLS) offered on the iHFG website, signup for HFBS using the link below.

Get Started Now:
hfbs.healthdesign.com.au

- ✓ iHFG Room Data Sheets and Departments are instantly editable in the HFBS software available online.
- ✓ You can access hundreds of report templates to print your iHFG room data in HFBS.
- ✓ HFBS has a onetime free 3 day trial available to all new users.

Get Started Now:
hfbs.healthdesign.com.au



HFBS

Health Facility Briefing System

hfbsinfo.com | techsupport@healthdesign.com.au